

## Transfer Chain Rear Case

### COMPONENTS

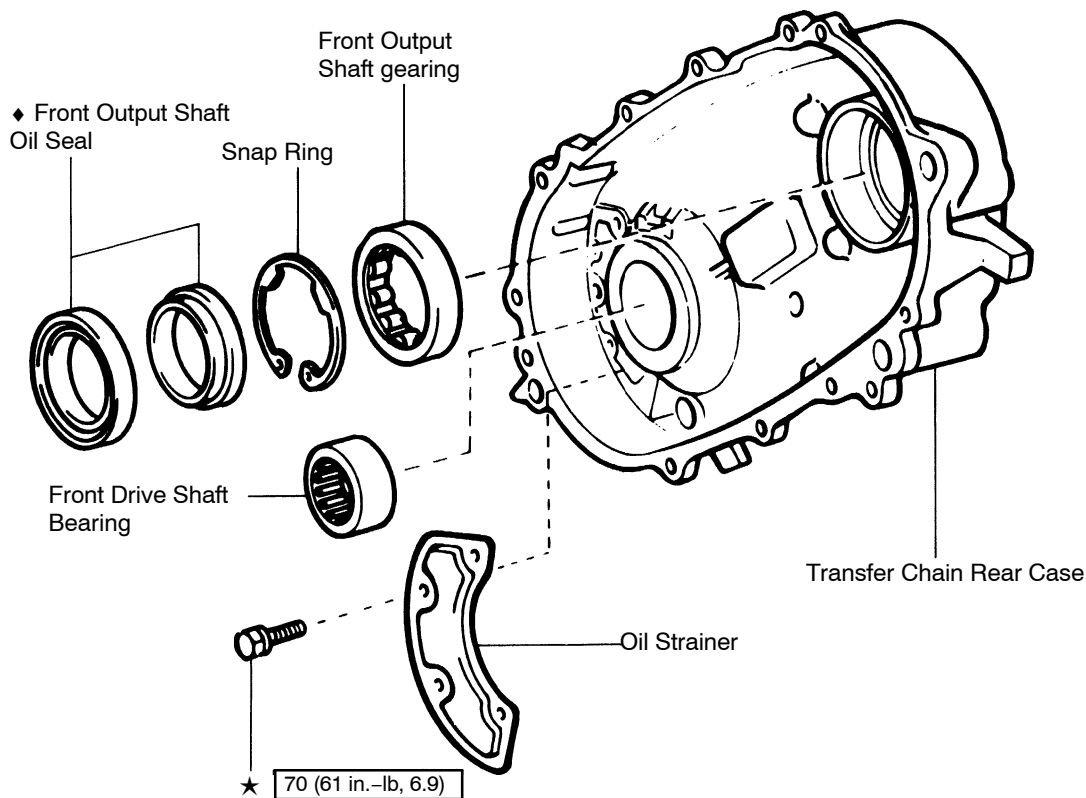

kg-cm (ft-lb, N-m) : Specified torque

◆ Non-reusable part

★ Precoated part

AT3300

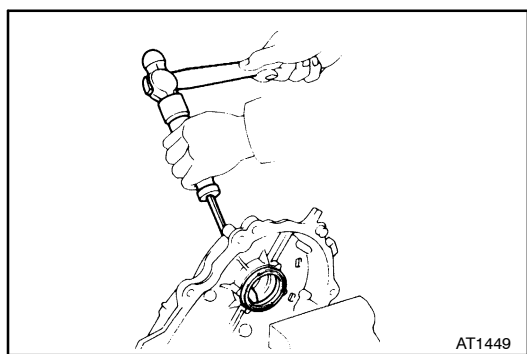

## DISASSEMBLY OF TRANSFER CHAIN REAR CASE

### 1. REMOVE FRONT OUTPUT SHAFT OIL SEALS

Using a screwdriver and hammer, drive out the two oil seals.

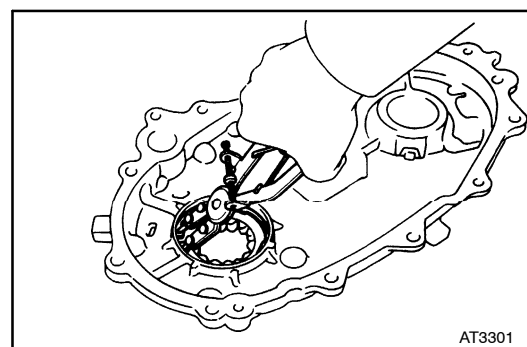

### 2. REMOVE FRONT OUTPUT SHAFT BEARING

- (a) Using snap ring pliers, remove the snap ring.
- (b) Remove the bearing.

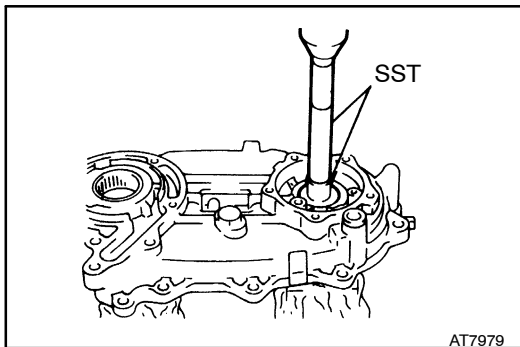

### 3. REMOVE FRONT DRIVE SHAFT BEARING

Using SST and a press, press out the bearing.

SST 09608-12010 (09608-00020, 09608-00040)

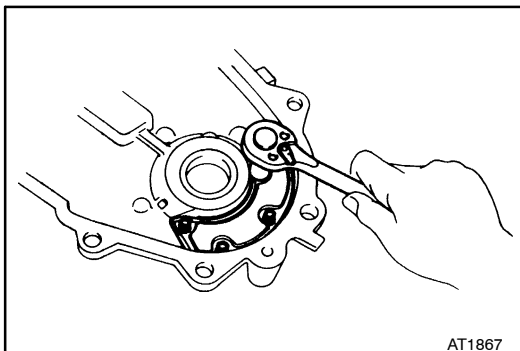

### 4. REMOVE OIL STRAINER

Remove the four bolts and strainer from the chain rear case.

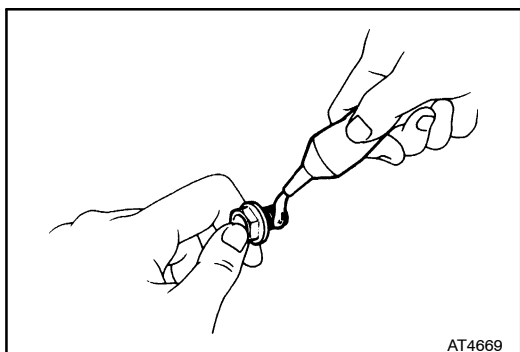

## ASSEMBLY OF TRANSFER CHAIN REAR CASE

### 1. INSTALL OIL STRAINER

(a) Apply sealant to 2 or 3 threads of the bolt end.

Sealant: Part No. 08833 – 00070, THREE BOND 1324 or equivalent

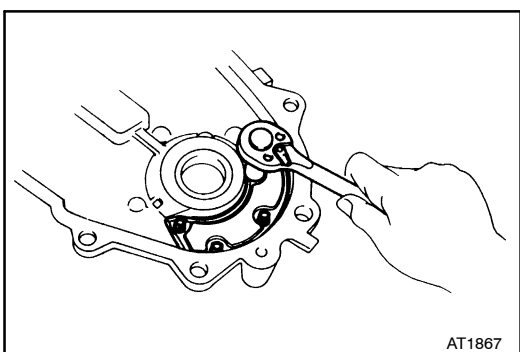

(b) Install the oil strainer with the four bolts.

Torque: 70 kg-cm (61 in.-lb, 6.9 N-m)

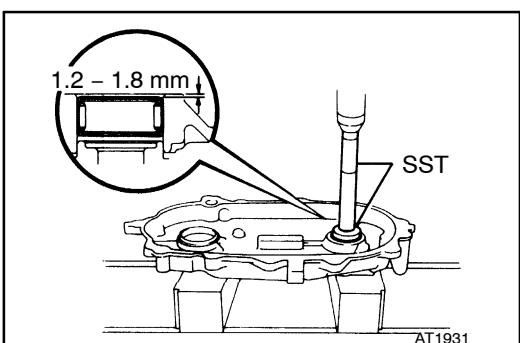

### 2. INSTALL FRONT DRIVE SHAFT BEARING

Using SST, press in the bearing.

SST 09608-12010 (09608-00020, 09608-00040)

Bearing depth: 1.2 – 1.8 mm (0.047 – 0.071 in.)

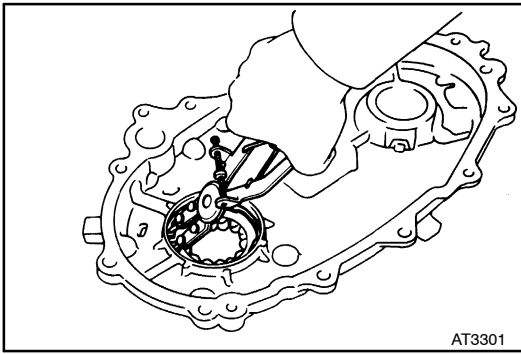

### 3. INSTALL FRONT OUTPUT SHAFT BEARING

- (a) Install the bearing to the transfer chain rear case.
- (b) Using snap ring pliers, install the snap ring.

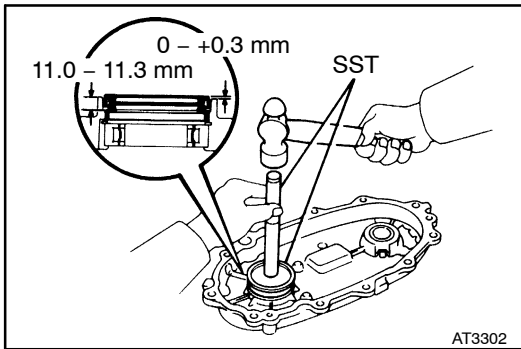

### 4. INSTALL FRONT OUTPUT SHAFT OIL SEALS

- (a) Using SST and a hammer, drive in a new rear oil seal.

SST 09608-32010 and 09608-35014 (09608-06020)

**Oil seal depth: 11.0 – 11.3 mm (0.433 – 0.445 in.)**

- (b) Using SST and a hammer, drive in a new front oil seal.

SST 09608-32010 and 09608-35014 (09608-06020)

**Oil seal depth: 0 – +0.3 mm (0 – +0.012 in.)**

- (c) Coat the oil seal lips with MP grease.